

MTF 160 160 SIZE MINI RACE QUAD

User Manual

V1.0

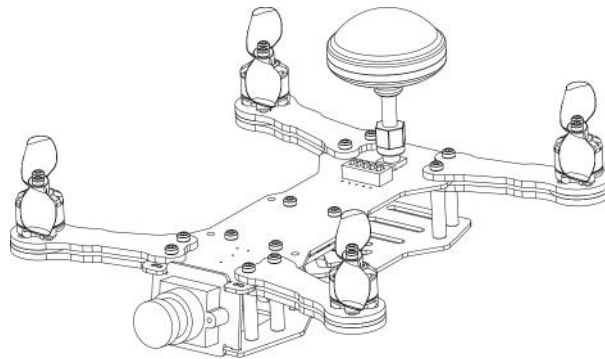

Disclaimer and Warning

Thank you for purchasing the MTF160.

Please read this instruction manual carefully before using this product. By using this product, you hereby agree to this disclaimer and signify that you have read it in full.

Please mount and use this product as per this manual strictly. As the manufacturer has no control over use, setup, final assembly, modification (including use other parts such as motor, ESC, propeller etc), no liability shall be assumed nor accepted for any resulting damage or injury.

As it may cause wireless interference in the living environment, please take effective measures to avoid it.

Any parts of this manual is subjected to change without prior notice.

Any problems while mounting this frame, please contact us or authorized agents

Introduction

MTF160 is a micro racer for FPV hobbyists. It is a highly integrated product with highly flexible control. Combo with motor 1104-4000KV, propeller 3x2" as well as the popular high quality 10A esc with BLHeli firmware (support ONESHOT ultra high speed). Flight range of remote control more than 1000 meters.

To gain the quality and real-time shoot for FPV, MTF160 also combines 5.8G 32CH 200mW transmitter with 1/3" CMOS lens, which supports 127 or wider 160° shootings and every moment brings you the exciting FPV experience.

The default firmware of FC is CleanFlight, It can be used after connected the battery, receiver and set the remote control. MTF160 supports to be flashed Openpilot, there will be with the different experience for you!

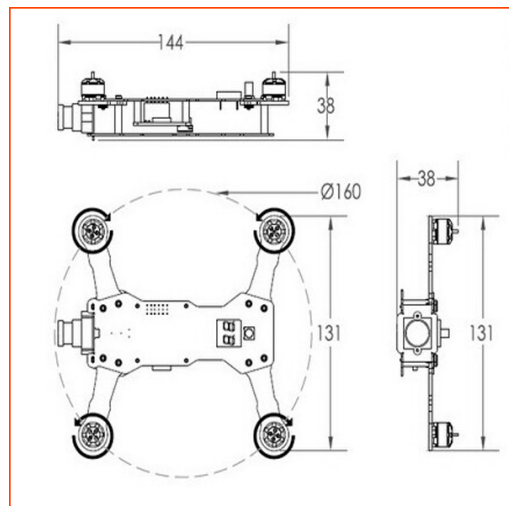

Box List

MTF160 frame	1pcs
Propeller 3020	2 Pair
5.8G antennas	1pcs
Screw M2x6 for propeller	10pc

MTF160 Power Set				
Flight Controller	CC3D (Pre-tuned CleanFlight)	Motor	1104/4000KV	Weight:110g (Excluding Battery)
Propellor	3 x 2"	Transmitter	5.8G 200mW/32CH	
ESC	10A (BLHeli FW)	Battery	Support 2~3S	
Lens	1/3" CMOS Lens FOV:160 Deg	(Excluded)	3S 1200~1600 (25-30C	

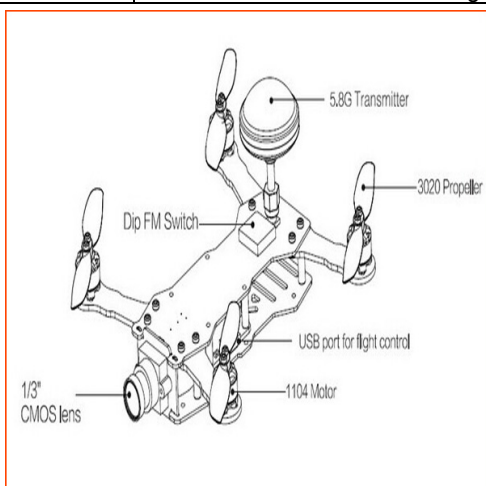

Switch frequency selection

Dial Switch 12345 to choose the required FR/CH for 32 channels

FR																			
FR1 (A)					FR2 (B)					FR3 (C)					FR4 (D)				
<input type="checkbox"/>	<input type="checkbox"/>	<input type="checkbox"/>	<input type="checkbox"/>	<input type="checkbox"/>	<input type="checkbox"/>	<input type="checkbox"/>	<input type="checkbox"/>	<input type="checkbox"/>	<input type="checkbox"/>	<input type="checkbox"/>	<input type="checkbox"/>	<input type="checkbox"/>	<input type="checkbox"/>	<input type="checkbox"/>	<input type="checkbox"/>	<input type="checkbox"/>	<input type="checkbox"/>	<input type="checkbox"/>	<input type="checkbox"/>
1	2	3	4	5	1	2	3	4	5	1	2	3	4	5	1	2	3	4	5
CH																			
CH1					CH2					CH3					CH4				
<input type="checkbox"/>	<input type="checkbox"/>	<input type="checkbox"/>	<input type="checkbox"/>	<input type="checkbox"/>	<input type="checkbox"/>	<input type="checkbox"/>	<input type="checkbox"/>	<input type="checkbox"/>	<input type="checkbox"/>	<input type="checkbox"/>	<input type="checkbox"/>	<input type="checkbox"/>	<input type="checkbox"/>	<input type="checkbox"/>	<input type="checkbox"/>	<input type="checkbox"/>	<input type="checkbox"/>	<input type="checkbox"/>	<input type="checkbox"/>
1	2	3	4	5	1	2	3	4	5	1	2	3	4	5	1	2	3	4	5
CH5					CH6					CH7					CH8				
<input type="checkbox"/>	<input type="checkbox"/>	<input type="checkbox"/>	<input type="checkbox"/>	<input type="checkbox"/>	<input type="checkbox"/>	<input type="checkbox"/>	<input type="checkbox"/>	<input type="checkbox"/>	<input type="checkbox"/>	<input type="checkbox"/>	<input type="checkbox"/>	<input type="checkbox"/>	<input type="checkbox"/>	<input type="checkbox"/>	<input type="checkbox"/>	<input type="checkbox"/>	<input type="checkbox"/>	<input type="checkbox"/>	<input type="checkbox"/>
1	2	3	4	5	1	2	3	4	5	1	2	3	4	5	1	2	3	4	5
CH		CH																	
FR		CH1	CH2	CH3	CH4	CH5	CH6	CH7	CH8										
FR	FR1	5865M	5845M	5825M	5805M	5785M	5765M	5745M	5725M										
	FR2	5733M	5752M	5771M	5790M	5809M	5828M	5847M	5866M										
	FR3	5705M	5685M	5665M	5645M	5885M	5905M	5925M	5945M										
	FR4	5740M	5760M	5780M	5800M	5820M	5840M	5860M	5880M										

Installation

- 1. Mount the 5.8G antenna a picture shows
- 2. Mount the propeller properly as picture shows

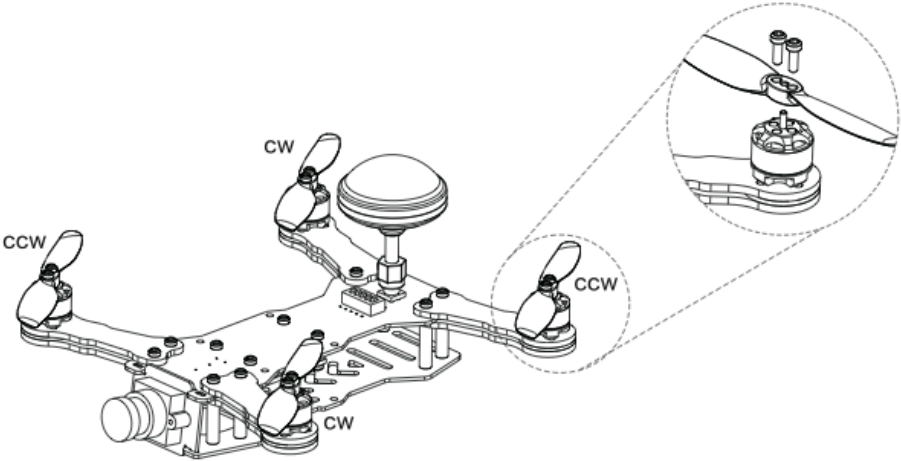

Connection diagram

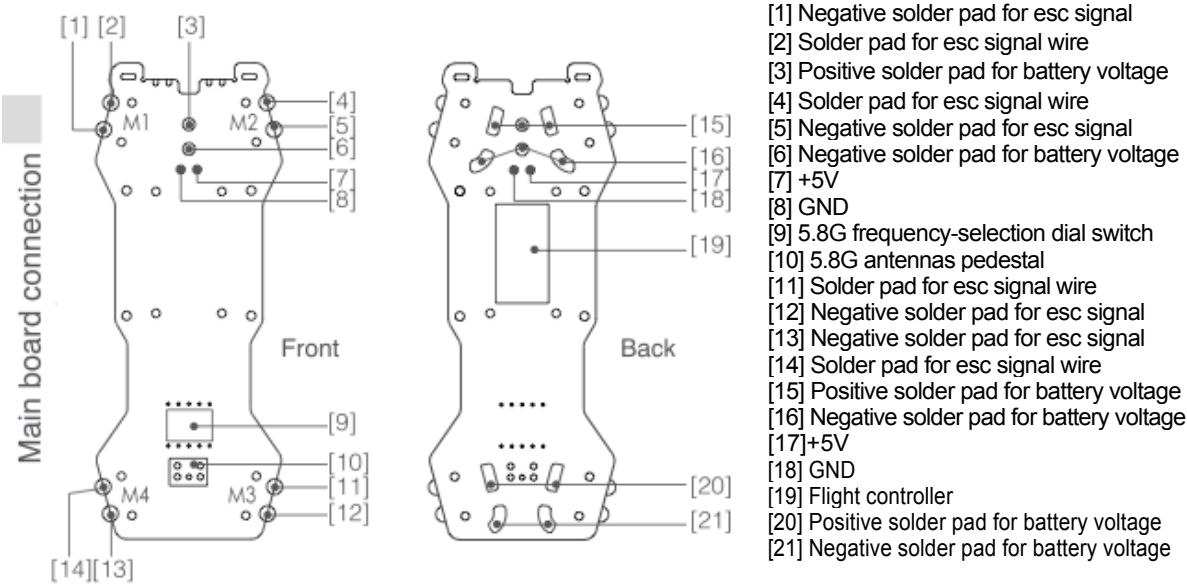

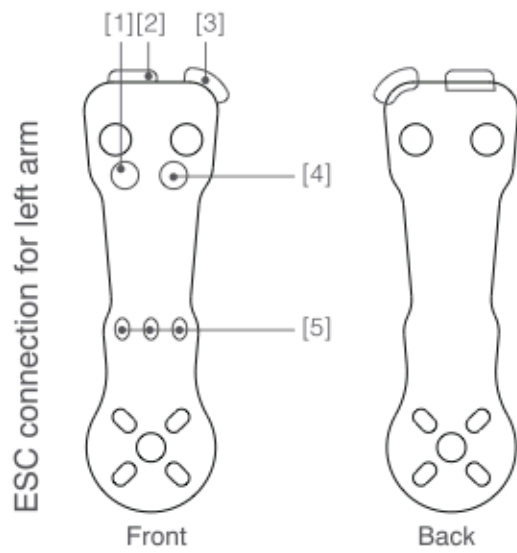

- [1] Solder pad for esc signal wire
- [2] Positive solder pad for battery voltage
- [3] Negative solder pad for battery voltage
- [4] Negative solder pad for esc signal
- [5] Solder pad for motor

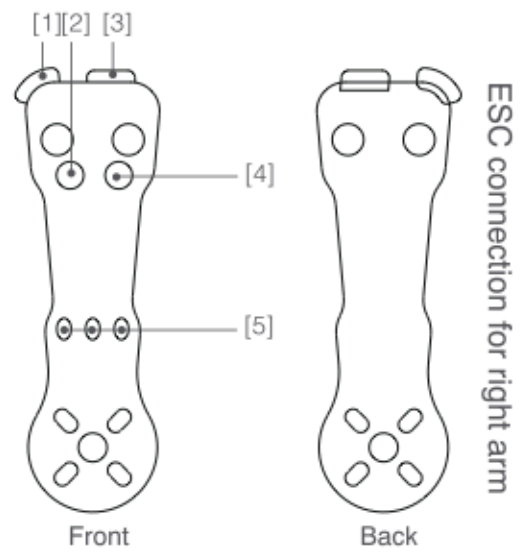

- [1] Negative solder pad for battery voltage
- [2] Negative solder pad for esc signal
- [3] Positive solder pad for battery voltage
- [4] Solder pad for esc signal wire
- [5] Solder pad for motor